

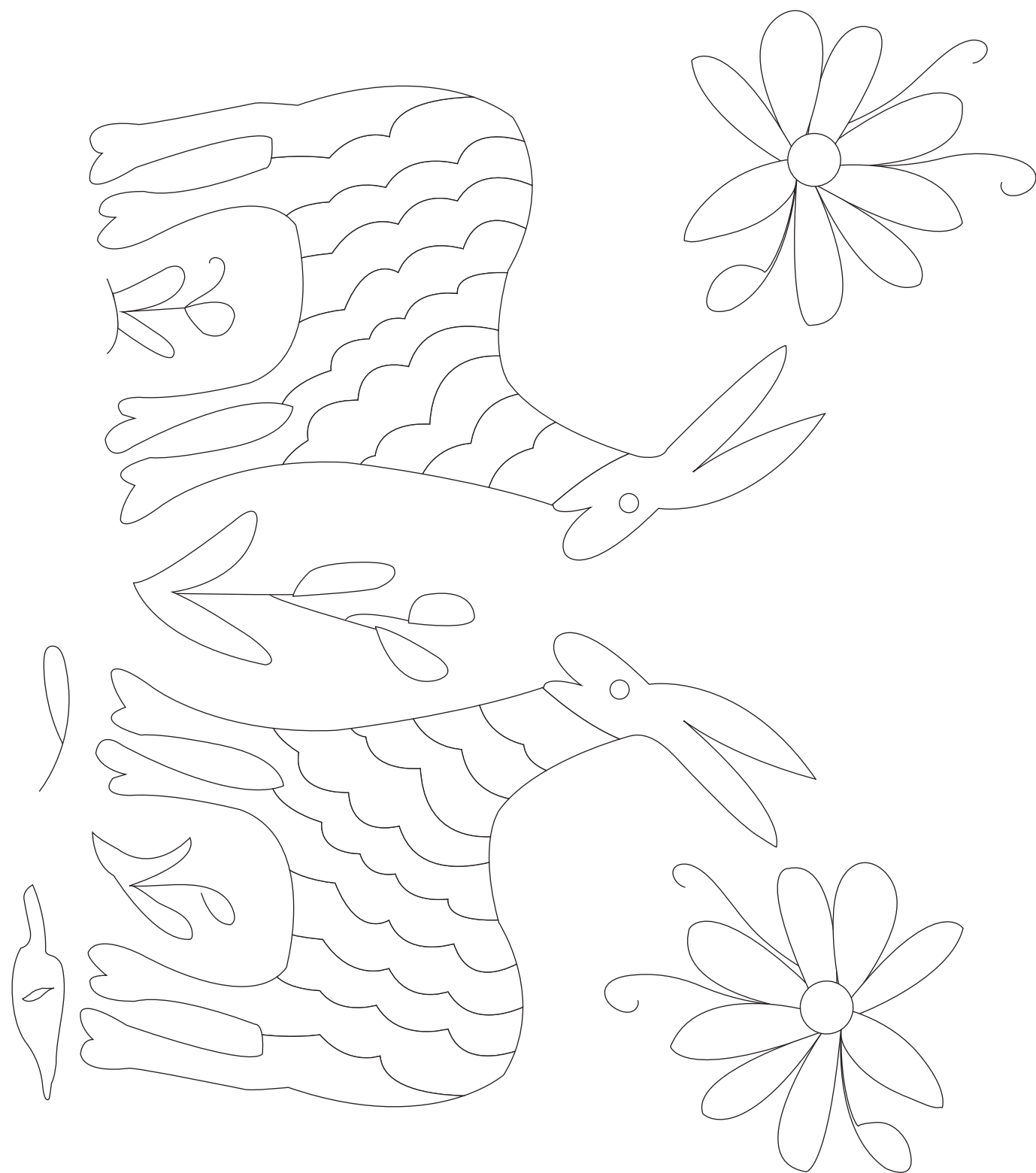

Around The World -Perro Llanero

Design Sheet / Feuille avec motif



Around The World -Perro Llanero

Getting Started / Commencer



Tool Kit / Fournitures



















DMC Mouliné Special embroidery thread 117MC / Fils Mouliné Spécial DMC
Fabric of your choice / Tissu de votre choix
Needle (will depend on your fabric) / Aiguille (dépendra de votre tissu)
Magic sheet or transfer pen and paper / Feuille magique ou stylo transfert et papier
Embroidery hoop (optional) / Tambour (optionnel)
Scissors / Ciseaux

Design size 18 x 20.5 cm / 7.1 x 8 " based on magic sheet

Embroidery Thread Colours

Fil à broder couleurs

Mouliné Special

Symbol Symbole	Colour Couleur	N° skeins* N° d'échevettes*
1	 720	x 1
2	 722	x 1
3	 742	x 1
4	 972	x 1
5	 743	x 1
6	 958	x 1
7	 3849	x 1
8	 3689	x 1
9	 3802	x 1
10	 3607	x 1
11	 349	x 1
12	 666	x 1
13	 891	x 1
14	 326	x 1
15	 336	x 1
16	 796	x 1
17	 826	x 1
18	 3838	x 1
19	 341	x 1

* Based on the pre-printed magic sheet size using the number of strands shown above right.
Basé sur la taille de la feuille magique pré-imprimée utilisant le nombre de brins montré ci-dessus à droite.

Embroidery Stitches / Points de broderie

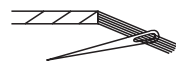

Use 6 strands
Utiliser 6 brins



A
Satin stitch
Passé plat

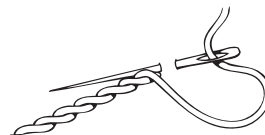

B
Stem stitch
Point de tige

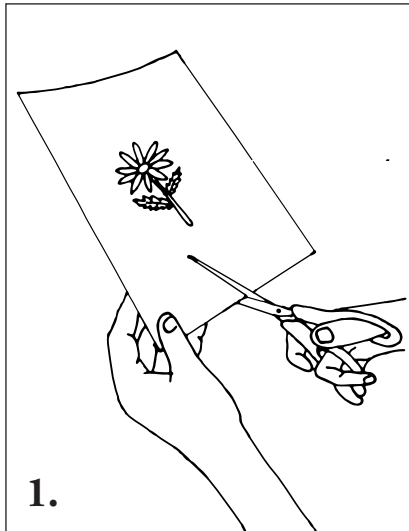

1.

Working on a flat surface assemble your tool kit and the base fabric you want to customise.

If necessary trim your magic sheet to a 2cm border around your design.

En travaillant sur une surface plane, rassemblez vos fournitures et le tissu que vous voulez customiser.

Si nécessaire, découpez la feuille magique à 2cm du bord autour de votre motif.

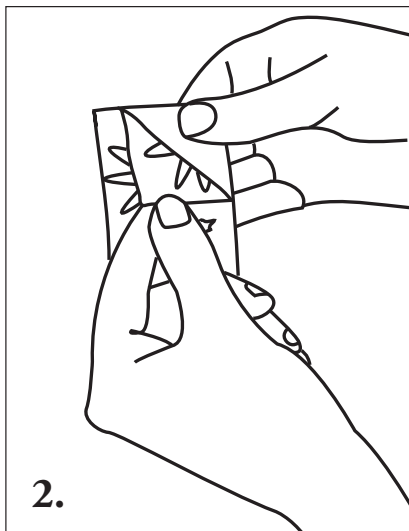

2.

Peel the backing paper from your design.

Décollez le papier derrière votre motif.

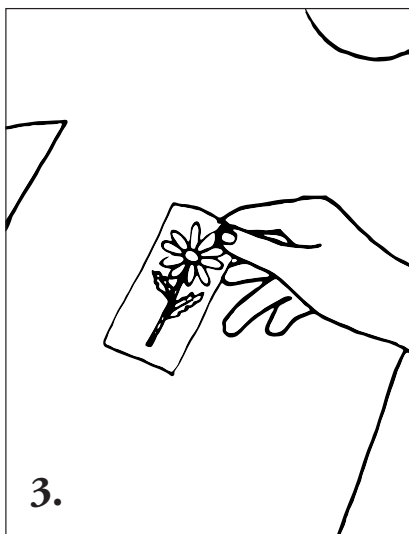

3.

Position your design where you'd like it. Don't worry, you can reposition it if it's not quite right.

Positionnez le motif où vous voulez. Ne vous inquiétez pas, vous pouvez le repositionner si besoin.

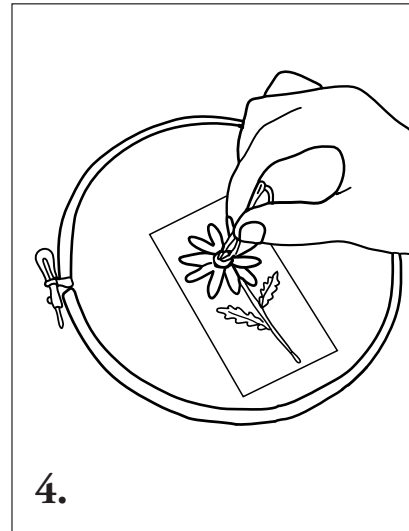

4.

Now you can hoop your fabric and start stitching your design following the embroidery chart.

Maintenant, vous pouvez fixer le tissu dans le tambour et commencer à broder votre motif en suivant le diagramme.

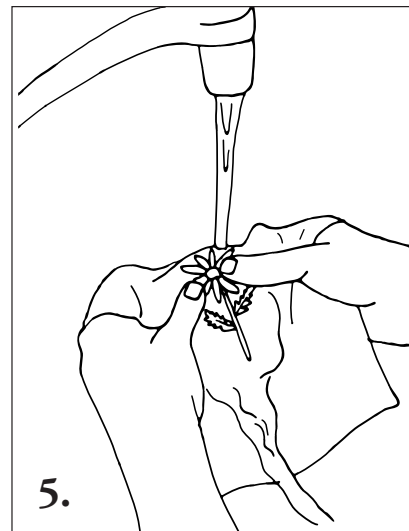

5.

Once you've finished stitching, rinse your fabric in cold water to dissolve the magic sheet, then let it dry.

Une fois que vous avez terminé de broder, rincez le tissu sous l'eau froide pour dissoudre la feuille magique. Ensuite, laissez sécher.



6.

Enjoy your custom embroidered creation!

Profitez de votre création brodée !

Around The World -Perro Llanero

Transfer Pen Method / Méthode avec Stylo Transfert

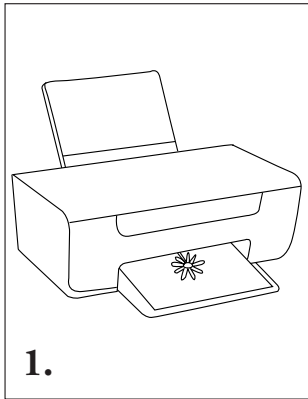

1.

Download your design sheet and print it at 100% on A4 / US letter format.

Téléchargez votre motif et imprimez-le sur une feuille A4.

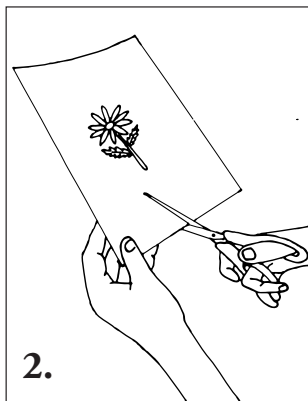

2.

If necessary trim around your design leaving a 2cm border.

Then place it face up on a flat surface.

Si nécessaire, découpez la feuille magique à 2cm du bord autour de votre motif.

Placez le motif face vers le haut sur une surface plane.

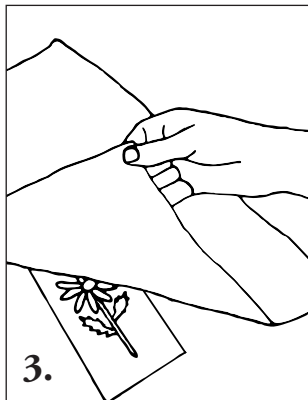

3.

Decide where you want your embroidery, then place your fabric on top of your design, securing it using sewing pins or masking tape.

Décidez où vous voulez placer votre broderie et posez le tissu au-dessus de votre motif, en le fixant avec des épingles ou du masking tape.

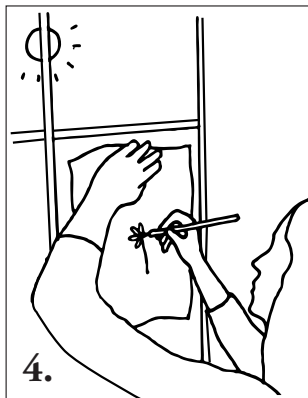

4.

With your design held firmly in place, hold your fabric against a lightbox or similar light source and trace your design onto your fabric using a water soluble transfer pen.

Lorsque votre dessin est bien maintenu, tenez votre tissu contre une table lumineuse ou une source de lumière similaire et tracez votre motif sur le tissu en utilisant un stylo transfert.

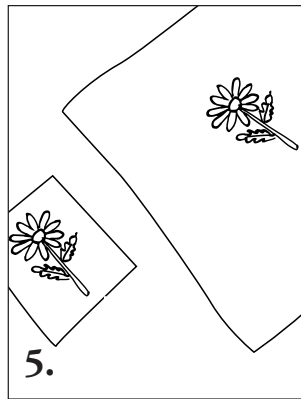

5.

Once you've traced your design, remove it from the back of your fabric.

Une fois que vous avez tracé votre motif, retirez-le du tissu.

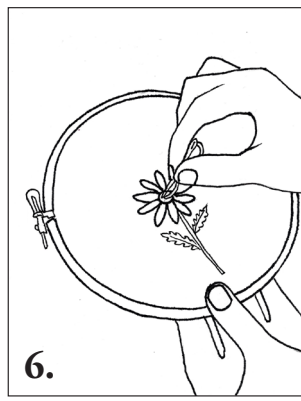

6.

Now you can hoop your fabric and start stitching your design following the embroidery chart.

Maintenant vous pouvez placer le tissu dans un tambour et commencer à broder votre motif en suivant le diagramme de broderie.

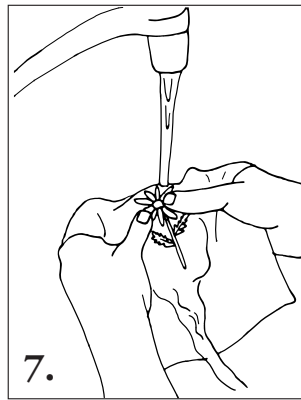

7.

Once you've finished stitching, rinse your fabric in cold water to remove the transfer pen ink, then let it dry.

Une fois que vous avez terminé, rincez le tissu sous l'eau froide pour retirer l'encre du stylo transfert et laissez sécher.

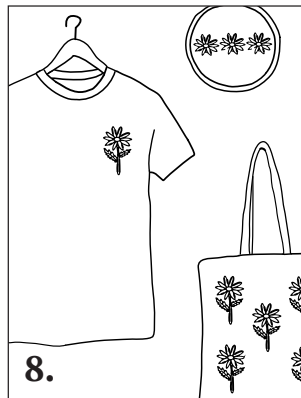

8.

Enjoy your custom embroidered creation!

Profitez de votre création brodée !